

MIOVA

user manual & warranty

**mima**[®]

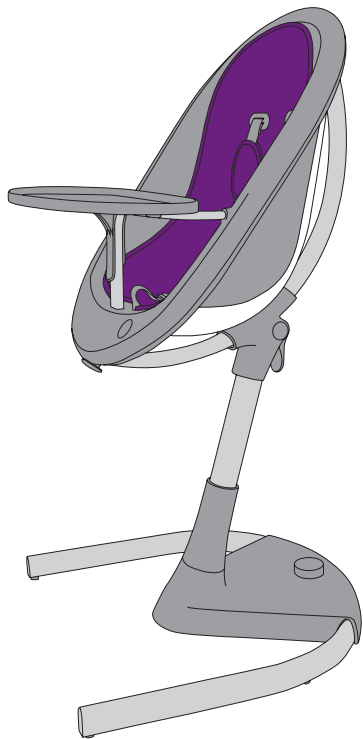

Dear parents, grandparents and friends:

Thank you for choosing **moon** and making it part of your family!

Our products are designed and developed with great care for the safety and comfort of your child. We hope you enjoy **moon**.

Please read these instructions carefully before using the chair for the first time, this will ensure safe usage of the product and enable you to find out about all its handy features.

mima

INDEX

WHAT YOU GET3

PLEASE NOTE.....4

FIRST STEPS.....7

STAGE 1: NEWBORN LOUNGER9
 NEWBORN LOUNGER MODE
 SAFETY HARNESS

STAGE 2: HIGH CHAIR10
 HIGH CHAIR MODE

STAGE 3: JUNIOR CHAIR.....11
 JUNIOR CHAIR MODE

ACCESSORIES11

CARE AND MAINTENANCE12

WARRANTY13

WHAT YOU GET

You should have one box with the chair and a bag with the seat pad. Please make sure that they contain all the parts that are listed below. If anything is missing, please contact your retailer.

Box:

- 1 base
- 1 pneumatic cylinder
- 1 cylinder cover
- 1 junior seat
- 1 high chair seat
- 1 safety harness
- 1 safety bar
- 1 tray
- 4 screws and Allen key

Seat Pad Bag:

- 1 seat cover
- 2 shoulder pads

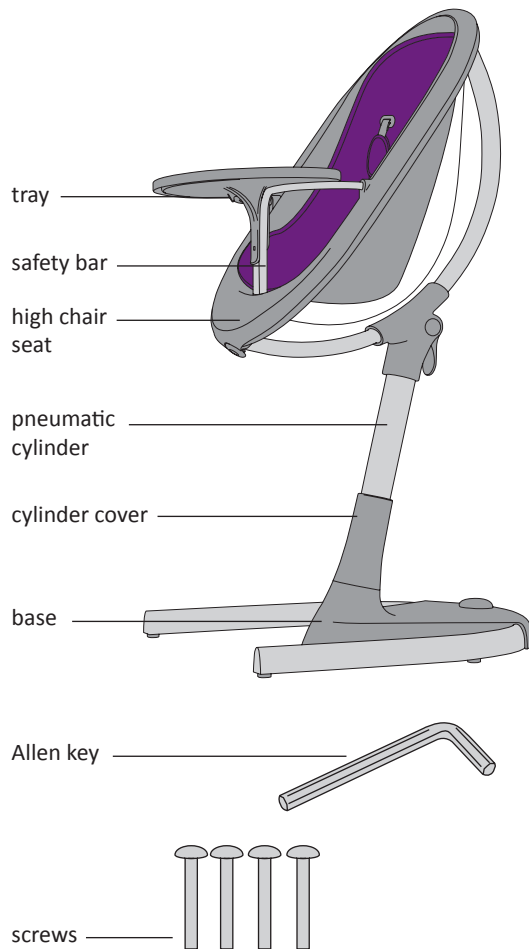
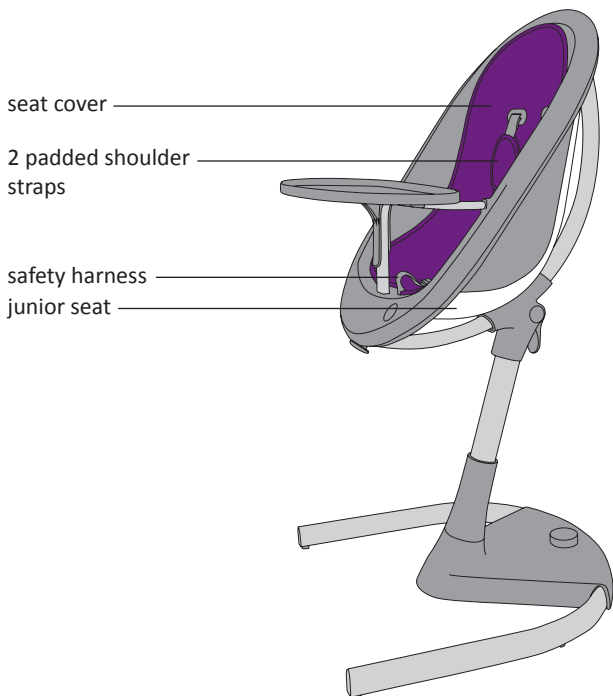

PLEASE NOTE

IMPORTANT!

Keep for future reference.

- Read these instructions very carefully before using the product. Failure to follow these instructions might put your child's safety at risk.
- The newborn lounger is suitable from 0- 6 months.
- The high chair is suitable from 6 months up to the age of 3 years. The maximum weight allowed is 15 kg.
- The junior seat and cushions make up the junior chair, which is suitable for children from 3 years of age to a maximum of 45 kg.

WARNING!

- Do not use the high chair until the child can sit up unaided.
- Your child's safety is your responsibility.
- Do not leave your child unattended, even for a short amount of time while in the chair.

- Make sure that the harness/restraining system has been put on and fits properly when your child is in the high chair, either in the reclining or upright position. —most injuries from high chairs are caused by falls or sliding out. The tray is not designed to hold the child in the chair.
- Make sure that all the users know how the chair works.
- Only use the chair on flat and stable surfaces.
- Do not let your child get in the high chair on their own to play or leave them in it unattended, even for a short amount of time. This chair is not a toy.
- Do not move the high chair around when your child is in it.
- Do not use the high chair if it is broken in any way or if any of its parts are missing.
- Do not use the junior chair for children younger than 3 years of age.
- The high chair is not designed to sleep in for long periods of time.
- Do not use accessories or replacement parts that are not sold by **mima**.

- Do not use the high chair unless all components are correctly fitted and adjusted.
- Be aware of the risk of open fire and other sources of strong heat, such as electric bar fires, gas fires etc. in the vicinity of the chair.
- Position the high chair away from solid structures and benches to avoid injuries caused by falls and by access to dangerous items.
- Use this high chair on an even, flat and horizontal surface and do not put the high chair on any high structure or table.
- To reduce the risk of injury, position the high chair away from furniture, walls, hot surfaces and liquids, window covering cords, and electrical cords and position the high chair away from furniture when the chair is not being used at table with the tray removed.
- The high chair should only be used in an upright position once the child is capable of reliably and consistently sitting upright unaided.

FIRST STEPS

1. Assembling the base

Put the base of the chair on the floor, insert the pneumatic cylinder, aligning the widest end of the cylinder with the corresponding groove at the base. Push the cylinder down to make sure that it fits into place properly.

2. Assembling the cylinder cover

Put the cylinder cover on and turn it around twice until it fits.

3. Assembling the seat

Insert the end of the seat frame in the cylinder and push downwards with your body weight to make sure it is secured on the cylinder. Lift the seat and if the base remains attached then the seat has been secured. Make sure that the cylinder goes into the end of the seat frame correctly.

4. Removing the high chair seat

Press the button at the bottom front of the seat to release it.

Lift it up and out, so that just the junior chair seat remains.

5. Assembling the safety bar

Install the safety bar on the high chair seat. First, fasten it on the side and then the screws underneath.

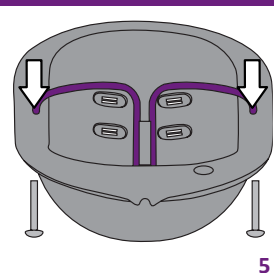
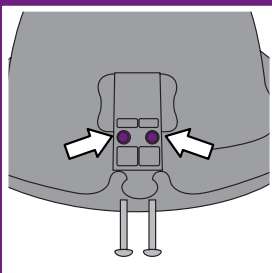
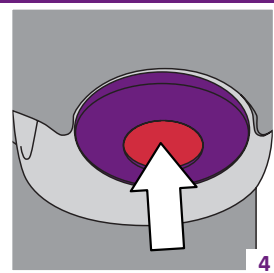
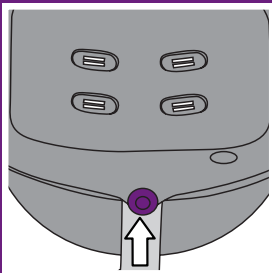
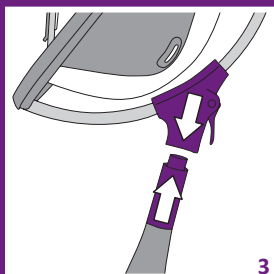
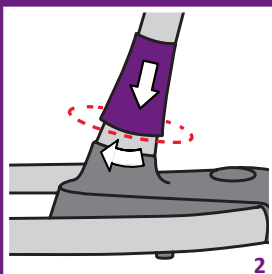
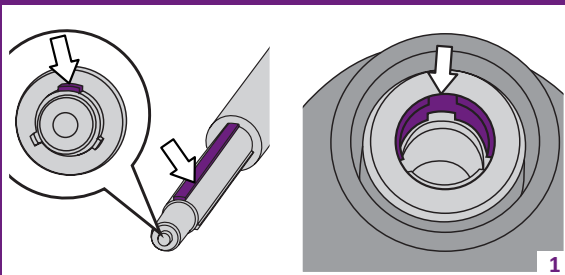

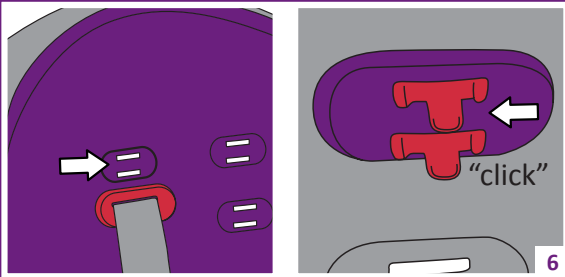

6. Assembling the seat cover and the safety harness

- **WARNING:** *Whenever your child is in the seat, make sure that the safety harness is nice and snug.*

Place the seat cover on the highchair.

The shoulder straps can be positioned at two different heights. Choose whichever position is closest to the upper part of the child's shoulders. Pull each one through the corresponding slot in the cover and the seat until they click into place.

7. Positioning the high chair

Reposition the high chair seat making sure that the pin in the top part goes into the slot of the junior seat and press downwards until it clicks into place.

8. Positioning the tray

Align the slots underneath the tray with the safety bar. Press down with your hands in the center of the tray until it fits into place and you hear a "click".

9. Seat height adjustment

Press the button on the base of **moon** with your foot and the seat will rise automatically. You may need to press the chair down slightly to activate the rising mechanism. Press the button on the base of **moon** with your foot and at the same time push the seat downwards to lower it. Lowering the seat is easier if you push down on the upper middle part of it. Raise your foot when the seat is at the desired height.

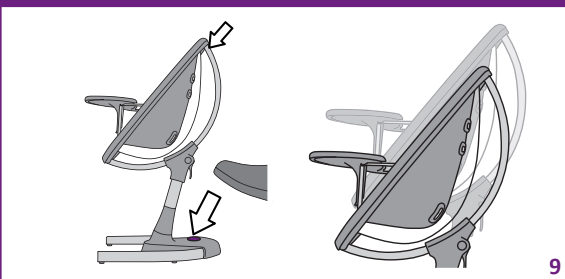
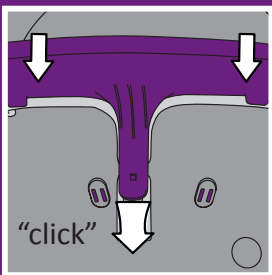
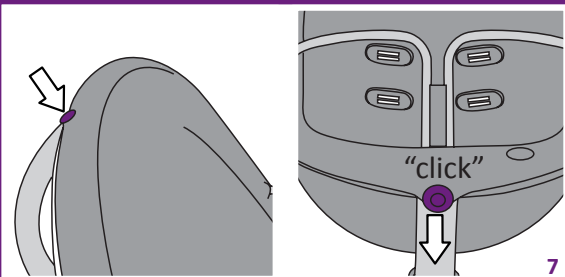

STAGE 1: NEWBORN LOUNGER

HIGH CHAIR SEAT

- **WARNING:** The high chair seat is suitable from 6 months up to the age of 3.
- When using **moon** for infants under 6 months, the seat must be used in the completely reclined position.
- Use the baby headrest (Sold separately) so that your baby's head is protected and is held in the right position.

10. Seat recline position adjustment

To adjust the recline position of the seat, lift the lever located under the seat and adjust it until the seat is completely reclined. Once in the desired position, lower the lever again to secure the seat.

11. Removing the tray

Pull the middle part of the rim of the tray from underneath so that it comes out of the clip and lift off the tray.

SAFETY HARNESS

- **WARNING:** Whenever your child is in the seat, make sure that the safety harness is nice and snug.
- The shoulder straps can be positioned at two different heights. Choose whichever position is closest to the upper part of the child's shoulders.

12. Fastening the harness

Insert the strap buckles into the slots and press until they click. Pull the ends of the straps to adjust the harness around the child so that it is nice and snug.

13. Unfastening the harness

Press the button in the middle of the buckle to release the harness.

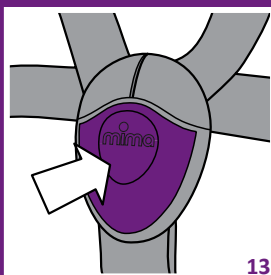
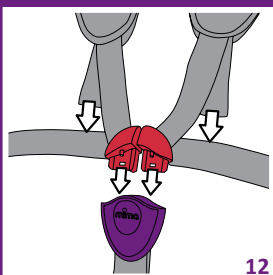
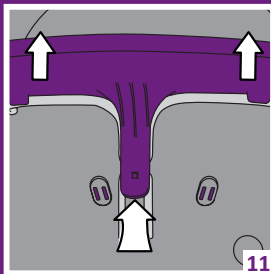
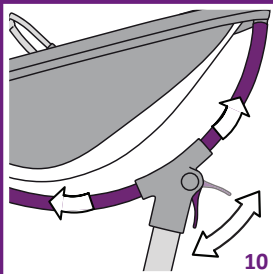

STAGE 2: HIGH CHAIR

- *moon* can be used from 6 months of age, when babies can sit up straight without help, up to the age of 3.
- **WARNING:** Never leave your child unattended without adult supervision. Your child's safety is your responsibility.
- Whenever you put your child in the high chair or change the position of the seat, make sure the harness is fitted correctly and is snug by adjusting the shoulder and waist straps.
- Check that the tray is secure by shaking it

14. Seat recline position adjustment

To adjust the reclining angle of the seat, lift the lever located under the seat and adjust it until it is in the sitting position. Lower the lever downwards again making sure that it has been adjusted properly.

15. Positioning the tray

Align the slots underneath the tray with the safety bar. Press down with your hands in the center of the tray until it fits into place and you hear a "click".

16. Seat height adjustment

Press the button on the base of *moon* with your foot and the seat will rise automatically. You may need to press the chair down slightly to activate the rising mechanism. Press the button on the base of *moon* with your foot and at the same time push the seat downwards to lower it.

Lowering the seat is easier if you push down on the upper middle part of it. Raise your foot when the seat is at the desired height.

17. Fastening the harness

Insert the buckles of the straps in the slots and press until they click. Pull the ends of the straps to adjust the harness around the child so that it is nice and snug.

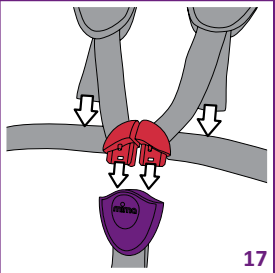
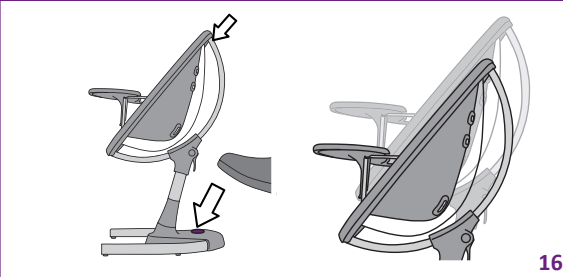
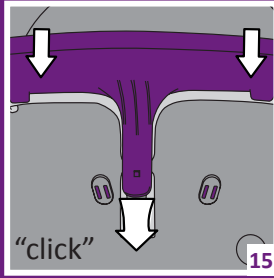
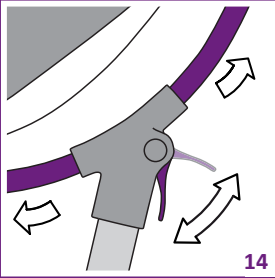

STAGE 3: JUNIOR CHAIR

JUNIOR CHAIR

- **WARNING:** The junior chair has been designed for children aged 3 and over.
- The specially designed cushions should be used for the seat (Sold separately).
- The recommended maximum weight is 45 Kg.
- It must be set to the lowest height.

18. Removing the high chair seat

Press the button at the bottom of the seat to release the high chair seat. Then lift and remove it.

19. Seat recline position adjustment

Adjust the angle of the seat to the almost upright sitting position. It is more comfortable with the cushions when it is slightly tilted and not totally upright.

20. Adding the junior chair cushions to the seat

Place the cushions on the seat. The largest goes on the base of the seat and the smaller at the back of the seat.

21. Height adjustment

Press the button on the base of **moon** with your foot and the seat will rise automatically. You may need to press the chair down slightly to activate the rising mechanism. Press the button on the base of **moon** with your foot and at the same time push the seat downwards to lower it. Lowering the seat is easier if you push down on the upper middle part of it. Raise your foot when the seat is at the desired height.

ACCESSORIES

We frequently update for moon accessories. For more details please visit www.mimakids.com or contact your retailer.

The following accessories are available to buy:

- *Adjustable foot rest*
- *Junior chair cushions*
- *Baby headrest*

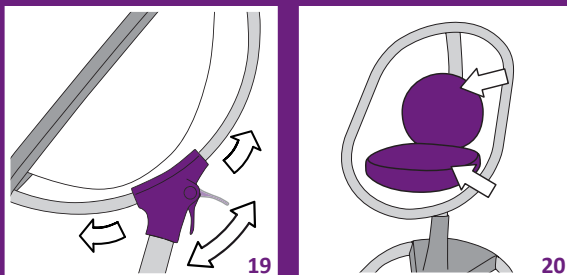
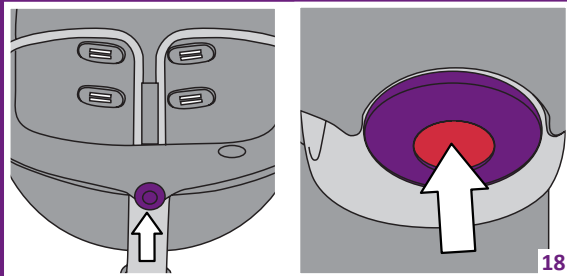

CARE AND MAINTENANCE

To keep the high chair in perfect condition, please bear in mind the following:

- The fabrics and plastics used, comply with the highest heat resistance standards. Nevertheless, the plastic could become yellowish over time. Direct exposure to sunlight will speed up this natural process; this is not considered to be a defect.
- To ensure that your chair and accessories last longer, keep **moon** clean and do not expose it to direct sunlight or heat sources.
- Check **moon** on a regular basis and make sure that the locking devices and the other parts are kept in good condition.
- Please contact your retailer if any of the parts need to be repaired or changed.
- Do not use **moon** if any of the parts are bent, broken or worn until they have been replaced.

CLEANING THE FRAME AND SEAT

- For a thorough cleaning, remove the seat cover and safety harness.
- Clean **moon** and its parts, including the tray with a damp cloth and a mild cleaning agent. Do not use abrasive detergents or whitening products.
- The tray can “not” be washed in the dishwasher.

CLEANING THE SEAT COVER

- Clean the cover with a damp cloth and a mild detergent.
- For big stains, remove the seat cover (see **fig. 6**) and wash it by hand, put a small amount of neutral detergent directly on the stain and rub it gently with a sponge. Rinse well and leave to dry before putting it back on the seat.
- The harness can be washed by hand. Remember to take the shoulder pads off and then put them back on when it has been washed and dried.

Please keep the following in mind:

- Clean with a damp cloth.
- Do not use bleach.
- Do not dry in clothing dryer.
- Do not iron.
- Do not dry clean.

WARRANTY

REGISTER YOUR PRODUCT ONLINE AT WWW.MIMAKIDS.COM

This will activate your warranty and help us to keep you informed about any possible product updates.

Your product complies with current safety requirements and is warranted to be free from any manufacturing or material defects at the time of purchase before first use.

If this product develops any problems through normal use during the warranty period, please contact your retailer.

WARRANTY CONDITIONS

- The warranty is valid for 24 months from the date of purchase. This warranty period cannot be extended even if the product has to be repaired.
- For the warranty to be valid you need to:
 1. Have registered your product online at www.mimakids.com
 2. Provide your retailer with the original receipt.
 3. Provide your retailer with a description of the defect.
- The warranty only covers the original owner of the product and cannot be transferred to any subsequent owner.
- The warranty entitles the owner to have the product repaired or replaced or a product refund will be granted at mima's sole discretion.

The warranty is not valid in the following circumstances:

- The product has been modified or repaired by a third party not authorized by mima.
- Corrosion or rust due to a lack maintenance and care.
- The defect was caused by improper use or maintenance.
- A defect was the result of an accident or damage by an airline/freight company.
- Normal wear and tear should be expected when this product is used daily.
- The fabric may become discolored or become damaged due to washing or excessive exposure to direct sunlight.

www.mimakids.com

All rights reserved © Mima International Ltd. 2013